

Location: DeWitt, NY  
 Intersection: Briarcliffe at Thompson Rd  
 Date: 10/05/2004  
 Weather: cloudy

*Briarcliffe Rd @ Thompson Rd*

File Name : BriarThmpsn  
 Site Code : 00000000  
 Start Date : 10/05/2004  
 Page : 1

Groups Printed: Unshifted - Heavy Vehicles - Buses

Start Time	THOMPSON Southbound					App. Total	THOMPSON Northbound					App. Total	BRIARCLIFFE Eastbound					Int. Total
	Righ t	Thru	Left	Ped s	App. Total		Righ t	Thru	Left	Ped s	App. Total		Righ t	Thru	Left	Ped s	App. Total	
Factor	1.0	1.0	1.0	1.0			1.0	1.0	1.0	1.0		1.0	1.0	1.0	1.0			
07:00	0	23	0	0	23	0	0	49	2	0	51	1	0	5	0	6	80	
07:15	0	28	0	1	29	0	0	52	0	0	52	2	0	3	0	5	86	
07:30	0	35	0	0	35	0	0	76	0	0	76	0	0	4	0	4	115	
07:45	0	52	0	0	52	0	0	81	0	0	81	1	0	4	0	5	138	
Total	0	138	0	1	139	0	0	258	2	0	260	4	0	16	0	20	419	
08:00	2	34	0	0	36	0	0	81	0	0	81	1	0	4	0	5	122	
08:15	2	40	0	0	42	0	0	81	0	0	81	1	0	6	0	7	130	
08:30	1	36	0	0	37	0	0	53	1	0	54	0	0	4	0	4	95	
08:45	0	45	0	0	45	0	0	56	0	0	56	0	0	7	0	7	108	
Total	5	155	0	0	160	0	0	271	1	0	272	2	0	21	0	23	455	
*** BREAK ***																		
16:00	3	74	0	0	77	0	0	49	1	0	50	0	0	1	0	1	128	
16:15	3	76	0	0	79	0	0	62	1	0	63	0	0	1	2	3	145	
16:30	4	90	0	0	94	0	0	61	2	1	64	0	0	1	0	1	159	
16:45	6	103	0	0	109	0	0	55	1	0	56	2	0	1	0	3	168	
Total	16	343	0	0	359	0	0	227	5	1	233	2	0	4	2	8	600	
17:00	2	85	0	0	87	0	0	78	0	0	78	0	0	4	0	4	169	
17:15	4	111	0	0	115	0	0	75	3	0	78	0	0	3	0	3	196	
17:30	2	96	0	1	99	0	0	79	2	1	82	0	0	3	0	3	184	
17:45	6	75	0	0	81	0	0	77	1	0	78	2	0	1	0	3	162	
Total	14	367	0	1	382	0	0	309	6	1	316	2	0	11	0	13	711	
Grand Total	35	1003	0	2	1040	0	0	1065	14	2	1081	10	0	52	2	64	2185	
Apprch %	3.4	96.4	0.0	0.2		0.0	0.0	98.5	1.3	0.2		15.6	0.0	81.3	3.1			
Total %	1.6	45.9	0.0	0.1	47.6	0.0	0.0	48.7	0.6	0.1	49.5	0.5	0.0	2.4	0.1	2.9		

SMTC

126 North Salina Street, Suite 100  
 Syracuse, NY 13202  
 (315) 422-5716

File Name : BriarThmpsn  
 Site Code : 00000000  
 Start Date : 10/05/2004  
 Page : 2

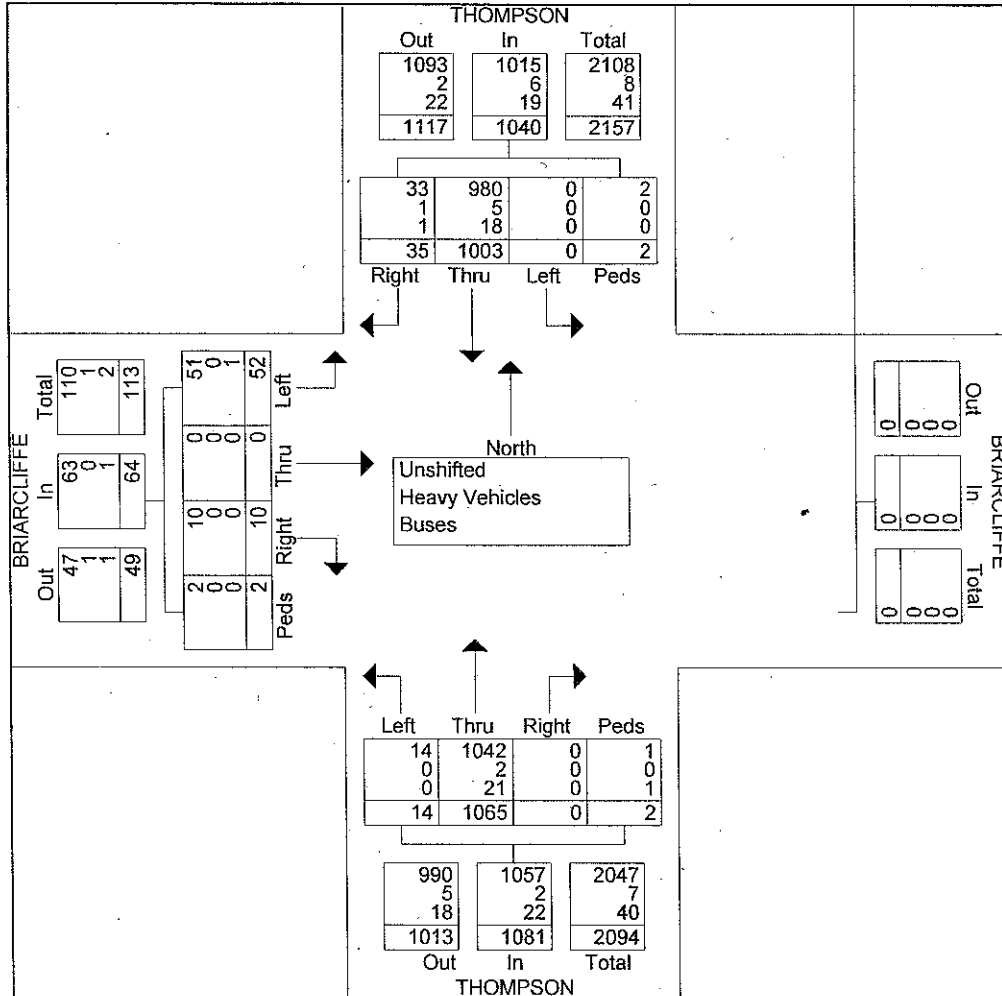

SMTC

126 North Salina Street, Suite 100 File Name : BriarThmpsn  
 Syracuse, NY 13202 Site Code : 00000000  
 (315) 422-5716 Start Date : 10/05/2004  
 Page : 3

Start Time	THOMPSON Southbound					App. Total	THOMPSON Northbound					App. Total	BRIARCLIFFE Eastbound					Int. Total
	Right	Thru	Left	Peds	App. Total		Right	Thru	Left	Peds	App. Total		Right	Thru	Left	Peds	App. Total	
Peak Hour From 07:00 to 11:45 - Peak 1 of 1 Intersection 07:30	4	161	0	0	165	0	0	319	0	0	319	3	0	18	0	21	505	
Volume	4	161	0	0	165	0	0	319	0	0	319	3	0	18	0	21	505	
Percent	2.4	97.6	0.0	0.0			0.0	100.0	0.0	0.0		14.3	0.0	85.7	0.0			
High Int. 07:45						6:45:00 AM	07:45					08:15					07:45	
Volume	2	52	0	0	52	0	0	81	0	0	81	1	0	6	0	7	138	
Peak Factor					0.793						0.985					0.750	0.915	

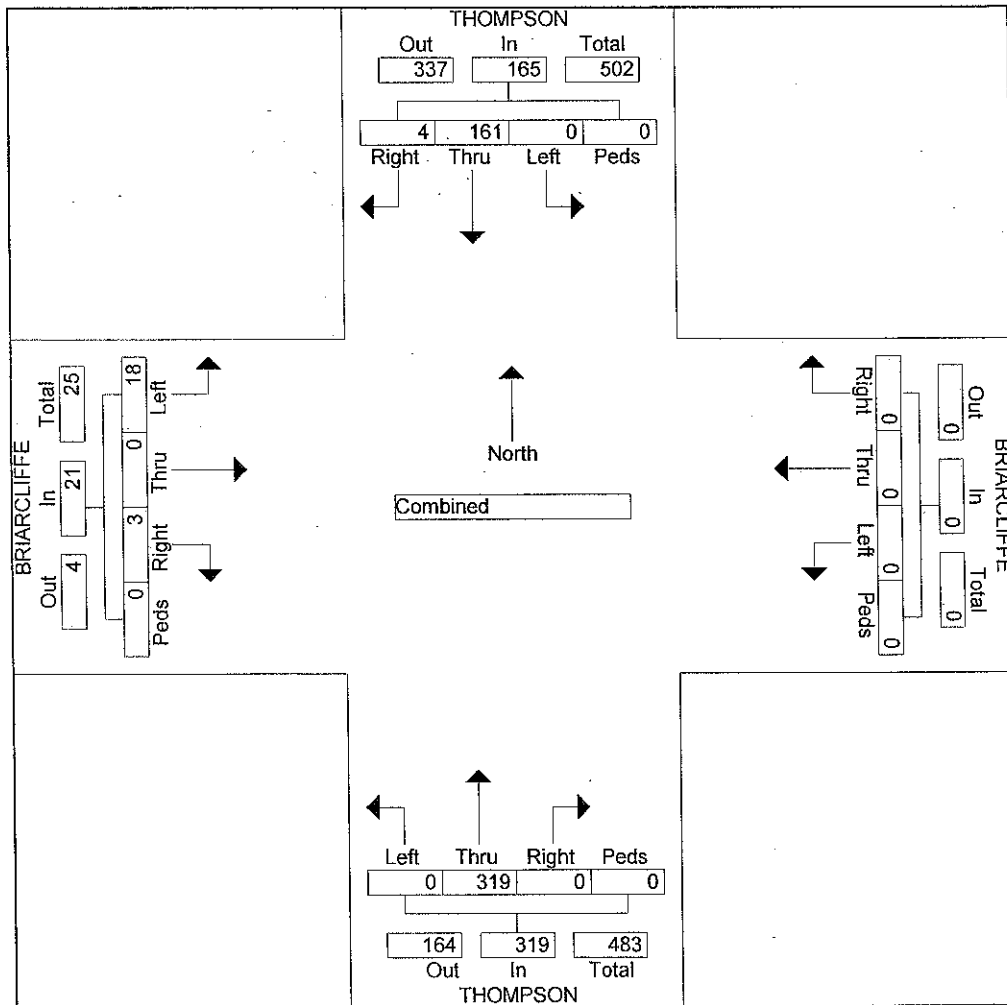

# SMTC

126 North Salina Street, Suite 100  
Syracuse, NY 13202  
(315) 422-5716

File Name : BriarThmpsn  
Site Code : 00000000  
Start Date : 10/05/2004  
Page : 4

Peak Hour From 12:00 to 17:45 - Peak 1 of 1

Intersection	16:45				
Volume	14	395	0	1	410
Percent	3.4	96.3	0.0	0.2	
High Int.	17:15				
Volume	6	111	0	1	115
Peak Factor					0.891

0	0	287	6	1	294	2	0	11	0	13	717
	0.0	97.6	2.0	0.3		15.4	0.0	84.6	0.0		
	17:30					17:00					17:15
0	0	79	3	1	82	2	0	4	0	4	196
	0.896					0.813					0.915

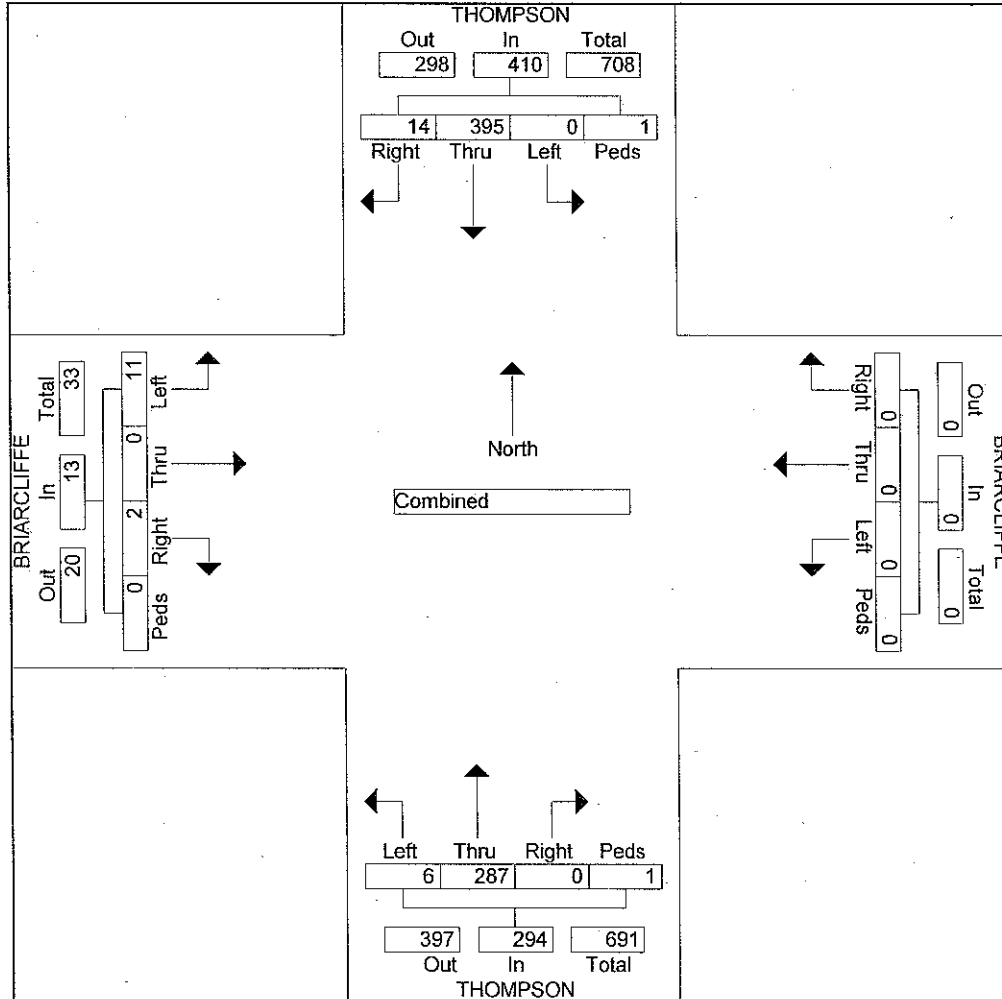



SMTC

Location: DeWitt, NY

126 North Salina Street, Suite 100

File Name : BriarThmpsn

Intersection: Briarcliffe at Thompson

Syracuse, NY 13202

Site Code : 00000000

Date: 10/05/2004

(315) 422-5716

Start Date : 10/05/2004

Weather: cloudy

Page : 1

Groups Printed: Buses

Start Time	THOMPSON Southbound					App. Total	THOMPSON Northbound					App. Total	BRIARCLIFFE Eastbound					Int. Total
	Righ t	Thru	Left	Ped s	App. Total		Righ t	Thru	Left	Ped s	App. Total		Righ t	Thru	Left	Ped s	App. Total	
Factor	1.0	1.0	1.0	1.0			1.0	1.0	1.0	1.0		1.0	1.0	1.0	1.0			
07:00	0	0	0	0	0	0	0	3	0	0	3	0	0	0	0	0	3	
07:15	0	2	0	0	2	0	0	0	0	0	0	0	0	0	0	0	2	
07:30	0	5	0	0	5	0	0	6	0	0	6	0	0	0	0	0	11	
07:45	0	3	0	0	3	0	0	0	0	0	0	0	0	0	0	0	3	
Total	0	10	0	0	10	0	0	9	0	0	9	0	0	0	0	0	19	
08:00	0	0	0	0	0	0	0	3	0	0	3	0	0	0	0	0	3	
08:15	1	3	0	0	4	0	0	2	0	0	2	0	0	1	0	1	7	
08:30	0	2	0	0	2	0	0	0	0	0	0	0	0	0	0	0	2	
08:45	0	0	0	0	0	0	0	1	0	0	1	0	0	0	0	0	1	
Total	1	5	0	0	6	0	0	6	0	0	6	0	0	1	0	1	13	
*** BREAK ***																		
16:15	0	0	0	0	0	0	0	1	0	0	1	0	0	0	0	0	1	
16:30	0	2	0	0	2	0	0	0	0	0	0	0	0	0	0	0	2	
16:45	0	0	0	0	0	0	0	2	0	0	2	0	0	0	0	0	2	
Total	0	2	0	0	2	0	0	3	0	0	3	0	0	0	0	0	5	
17:00	0	1	0	0	1	0	0	0	0	0	0	0	0	0	0	0	1	
17:15	0	0	0	0	0	0	0	1	0	0	1	0	0	0	0	0	1	
17:30	0	0	0	0	0	0	0	1	0	1	2	0	0	0	0	0	2	
17:45	0	0	0	0	0	0	0	1	0	0	1	0	0	0	0	0	1	
Total	0	1	0	0	1	0	0	3	0	1	4	0	0	0	0	0	5	
Grand Total	1	18	0	0	19	0	0	21	0	1	22	0	0	1	0	1	42	
Apprch %	5.3	94.7	0.0	0.0			0.0	95.5	0.0	4.5		0.0	0.0	100.0	0.0			
Total %	2.4	42.9	0.0	0.0	45.2	0.0	0.0	50.0	0.0	2.4	52.4	0.0	0.0	2.4	0.0	2.4		